



LASALLE CURRENTS

A Newsletter For Members Of LaSalle Mariners Yacht Club

November 13th, 1979

AHOY YE MARINERS,

Whereas till now, the "Currents" were only being offered in one edition, we are very pleased to announce a new format, the early edition and our new late edition. This one definitely is a late edition. There are a great many things to write about, because a fine sailing summer it was, but we will do that next month. This issue will mainly be taken up by the reprint of the Club's five year plan as proposed by the Planning Committee and submitted at the last general meeting. It is a plan well worth studying and is to serve the executive and membership as a general guideline. It is not intended to be inflexible in its details nor are the financial figures calculated to the penny. The Planning Committee would love to receive your own ideas about the future you would like planned for your favorite yacht club, either verbally or on paper, they will listen anyway, don't throw this issue away!

Although Haul Out Day is always a very sad day, it has the feel of icy permanence, it was also a show of good team work and efficiency!! Yeah team... Utilization of the storage area to the east certainly makes hauling the boats much quicker, (knowing where the slings go also helps) and leaves the rest of the available area nearer to the Club House open. And the galley wasn't to be outdone by all the expertise outside!

We may see a couple of hardy souls sailing their light boats for a while yet.

A lot of cigars were seen being smoked last week at the Club, Why?? Well, the stork delivered a Big, Bouncing, Boy, Nicholas, to Jennifer and Jim Beaudoin's house. Congratulations!!!

Some new fiberglass babies have arrived, a nice yellow Northern -25 for Phil and June Smith, a shiny C & C 27 for Alex and Connie Buliga. Well the Doctor says, Rino and Vi Masotti are expecting an Abbott - 33, so are the Hendel's (overdue) and Bernie and Holly Wolter have a golden HR-25, (Bernie was seen sitting in the cockpit of his new vessel....in a downpour, in a trance, on dry land.....

On to the social happenings. The annual awards banquet will be on Saturday, November 17th, at Fogolar Furlan, 1800 E. C. Row, cocktails at 6:30 dinner at 7:30, \$10.00 per person, dancing. For tickets or reservations telephone Red at 258-7872, Margie at 734-1981. You can't afford to miss this one!!

Also thanks to all regular ghosts, goblins, witches, and to the unusual chicken, caterpillar, robot and also a special appearance of Bonnie and Clyde, for making this year's Halloween party a real success.

The Dart League has started its 79-80 season with six teams of five players each. The teams carry the names of the Great Lakes captained as follows:

SUPERIOR	-	D. Hendel
ONTARIO	-	J. Albrecht
ERIE	-	M. Fiedler
HURON	-	J. Blackton
ST. CLAIR	-	M. Geary
MICHIGAN	-	R. Munden

A third dart board had to be added to accommodate these enthusiastic players, a lot of them newcomers to the game. Play goes on at 7:30 p.m. every Wednesday come and watch, if not yet involved and sign on as a spare!!

Outside of Club Happenings:

Sun. Nov. 18 - 2:00 p.m.

Sailing films - Lasers, Hobies, Windsurfers, Refreshments at: Dockside Yachts
2650 Front Rd. LaSalle, 734-8022

Sat. Nov. 24 - 10:00 a.m.

Sail Seminar - slides, How-to, a day at the sail loft, lunch: Boston Sails
120 Michigan Ave. Pt. Edward - Sarnia, 344-5236. R.S.V.P. Phone J. Hendel
253-2533 (days) (bring your sails for check & repairs).

The next general meeting will be Sun., December 9th 10:00 at the Clubhouse
Agenda: Election & Change of Watch. The nominating committee has nominated
and is presenting the following slate of officers.

COMMODORE	Art Letts
VICE COMMODORE	Tennison Mason
SECRETARY	Yvonne McRobbie
TREASURER	Jim Beaudoin
DIRECTORS	Curley Ellis, Ralph Allen, John Geary, Rino Masotti

Nominations from the membership will be accepted by the nominating committee, R. Clark, Geo. Mooney, J. Hendel on November 29th, from 7:00 p.m.-9:00 p.m. at the Clubhouse. The nominees shall be presented by the persons nominating and seconding nominations in person. These nominees will be added to the above list for your vote on the date of the next general meeting, December 9th, 1979.

WATCH FOR THE EARLY EDITION!!!!!!

LASALLE MARINERS YACHT CLUB

5 YEAR PLAN 1980-1985

The following outline is a recommendation by your planning committee. We have listed in order of priority items beneficial to all and to make L.M.Y.C. the finest and most respected clubs in the area.

Please read and study this proposal carefully and feel free to express your opinions to any of the undersigned or to your executive.

Upon open discussion and ammendments, this plan should be adopted and followed to completion, with necessary funding being allotted each year by your executive.

Thank you ,

Richard Benning
Juergen Hendel
George Mooney

FUNDING.

MEMBERSHIP.

RECOMMENDATION-

- close membership at 100 members within the five year span.
- hold membership in abeyance until future expansion to property and facilities are deemed necessary and feasible by the membership.

INITIATION AND ANNUAL DUES.

RECOMMENDATION-

- maintain present initiation fee of \$400.00
- increase annual dues to \$100.00 as of 1980, and increase dues \$100 per year to 1985 and then hold at \$150.00 until the membership deems it necessary to adopt further increases.

DOCKAGE.

RECOMMENDATION-

- increase dockage fee to \$6.00 per linear foot in 1980.
- increase dockage fee to \$8.00 per linear foot in 1983.
- increase dockage fee to \$10.00 per linear foot in 1985, and then hold at that rate until the membership deems it necessary to adopt further increases.

WINTER STORAGE.

RECOMMENDATION-

- based on a square foot calculation (length x width - no $\frac{1}{2}$ foot) increase storage to 30¢ per square foot in 1980
- increase to 40¢ per square foot in 1983
- increase to 50¢ per square foot in 1985 and then hold at that rate until the membership deems it necessary to adopt further increases.

HARBOUR.

RECOMMENDATION-

- expand docking facilities to accommodate 25 more yachts due to expected increase in membership.

These increases are proposed in order to keep up with inflation and create a viable working base for improvements to harbour, property and buildings.

HARBOUR AND SHORELINE.

RIVERBANK AND CHANNEL AREAS.

RECOMMENDATION-

- immediate attention be given to outer point area.
- contract to line shoreline with large rubble stone 12" to 24" in size and laid in a semi-circular shape forming a rounded tip to the yacht club.
- contract to backfill new area and landscape with sod and heavy groundcover.
- approximate cost to complete the above would range from \$4000.00 to \$6000.00.
- north and south channel bank areas east of the stone breakwater should be lined with ten foot sheet steel ending at the western end of the harbour. It is felt because the steel can be driven from land and earth dredged up in front, the ten foot length is adequate.
- approximate cost to complete the above would range from \$60.00 to \$90.00 per linear foot.

HARBOUR.

RECOMMENDATION-

- upon investigation it is learned that clay ground becomes stable when laying at a 60* angle.
- contract to have north and south harbour shorelines scraped to a 45* angle after which sod should be laid from the waters edge and up the bank to form a green belt.
- straighten south harbour shoreline to conform to north shoreline.
- approximate cost to complete the above would range from \$4400.00 to \$6500.00.

WINTER STORAGE AND PARKING.

WINTER STORAGE.

RECOMMENDATION-

- increase size of parking area at the east end of the harbour for total winter boat storage.
- dredge boat handling slips on north and south sides, at the east end of the harbour. This will facilitate easy handling by a mobile crane.

PARKING.

RECOMMENDATION.

- eliminate all parking in front of boat wells and use new enlarged parking area at the east end of the harbour.
- contract to have new water, lighting and electrical conduit installed in existing parking area.
- contract to have existing parking lot scraped and landscaped with sod and trees according to plan. This will eliminate dust and dirt from blowing on the boats plus increasing picnic and recreation areas
- install identical shoreboxes at each dock.

DOCKS.

RECOMMENDATION.

- eliminate existing long docks.
- construct and install new floating docks which are removable in the winter thus eliminating ice damage.
- complete gin pole for use in the 1980 season.
- construct an eighty foot area of north shoreline for dinghies. Scrape to 45' and sod. Install a floating ramp.

BUILDINGS.

RECOMMENDATION.

- contract to have a new screened porch added to the front of the clubhouse. This should be constructed in such a manner as to provide an observation deck above our new addition and screened porch. It should be built in such a manner as to provide future total enclosure and winterizing. the porch addition shall reach out 16 ft. with an additional deck and steps reaching out 8ft. An iron spiral staircase shall provide access to the roof deck.
- approximate cost to complete the above would be \$6000.00 to \$8000.00.
- construct a new locker room for men and women on the north side of the clubhouse with access only from the outside. In addition extra room could be made for the galley and the bar area with access through the present galley. The locker room addition would provide needed area for toilet and changing facilities for members and guests.
- approximate cost to complete the above would be \$8000.00 to \$10,000.00.

RECREATIONAL FACILITIES.

RECOMMENDATION-

- contract to have a 20ft x 40ft swimming pool constructed surrounded by a 10ft concrete pad.
- contract to have a 40ft x 80ft tennis court constructed directly west of the swimming pool. Both areas should have a proper fence built to provide proper protection and safety. In the tennis court area additional basketball volleyball and handball facilities could be added, thus providing a wide spectrum of additional sports availability.
- approximate cost to complete the above would be \$16,000.00 to \$22,000.00.

LAND ACQUISITION AND FUTURE EXPANSION.

RECOMMENDATION-

Harbour- new wells- north harbour only.

Land -

Look to purchase land directly to the north, approximately 6 acres. This land would ease future harbour expansion and would provide an opportunity for the club to enter into the development business, creating a possible mariners condominium and townhouse complex.

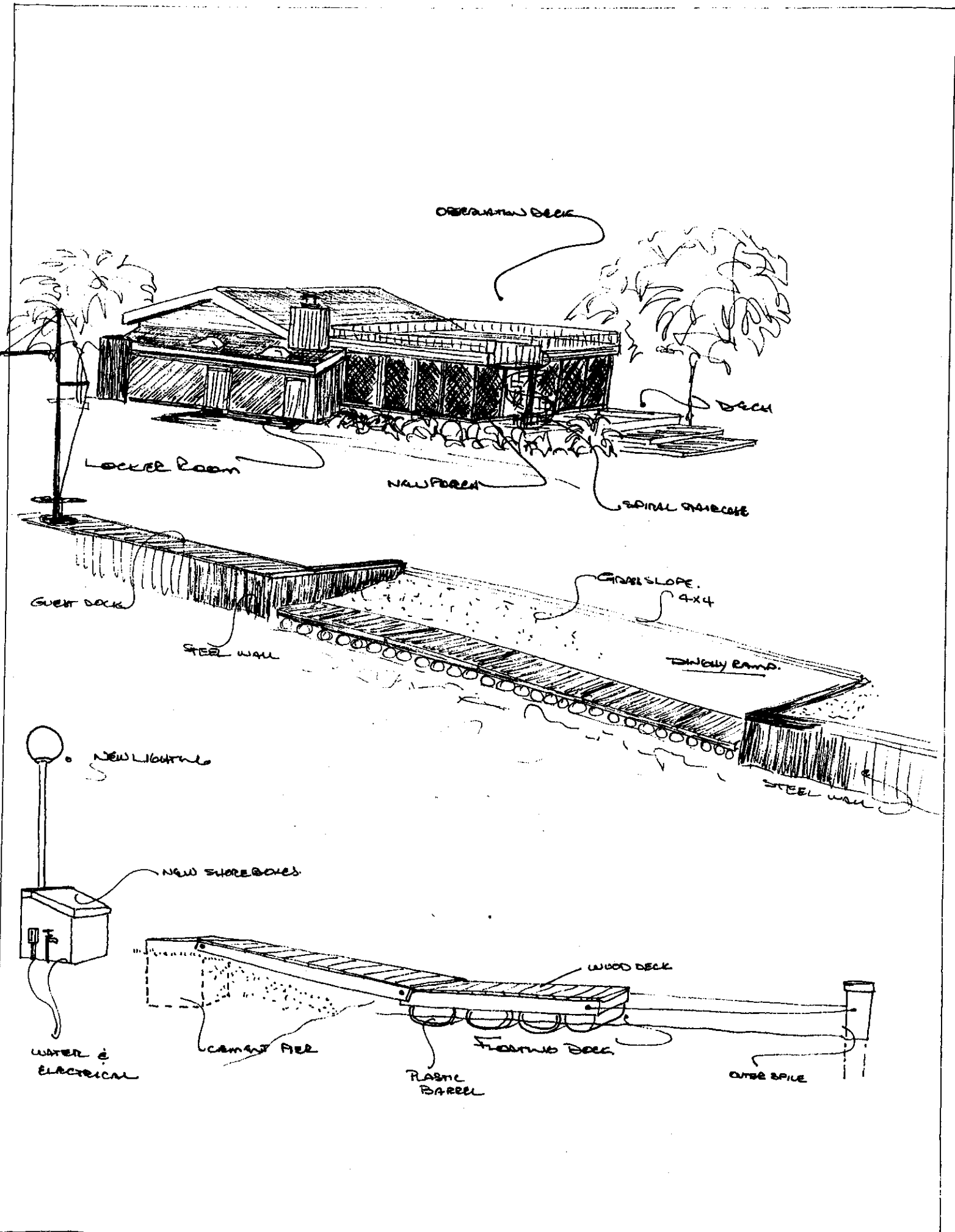

OPERATION DECK

Locker Room

NAU DECK

SPINAL STAIRCASE

GUEST DECK

STEEL WALL

GRADE SLOPE
4x4

DIBBY RAMP

STEEL WALL

NEW LIGHTING

NEW SHORE BOXES

WATER &
ELECTRICAL

Cement Pier

WOOD DECK

PLASTIC
BARREL

Floating Deck

OUTER SPIRE

LASALLE MARINERS YACHT CLUB

DETROIT RIVER

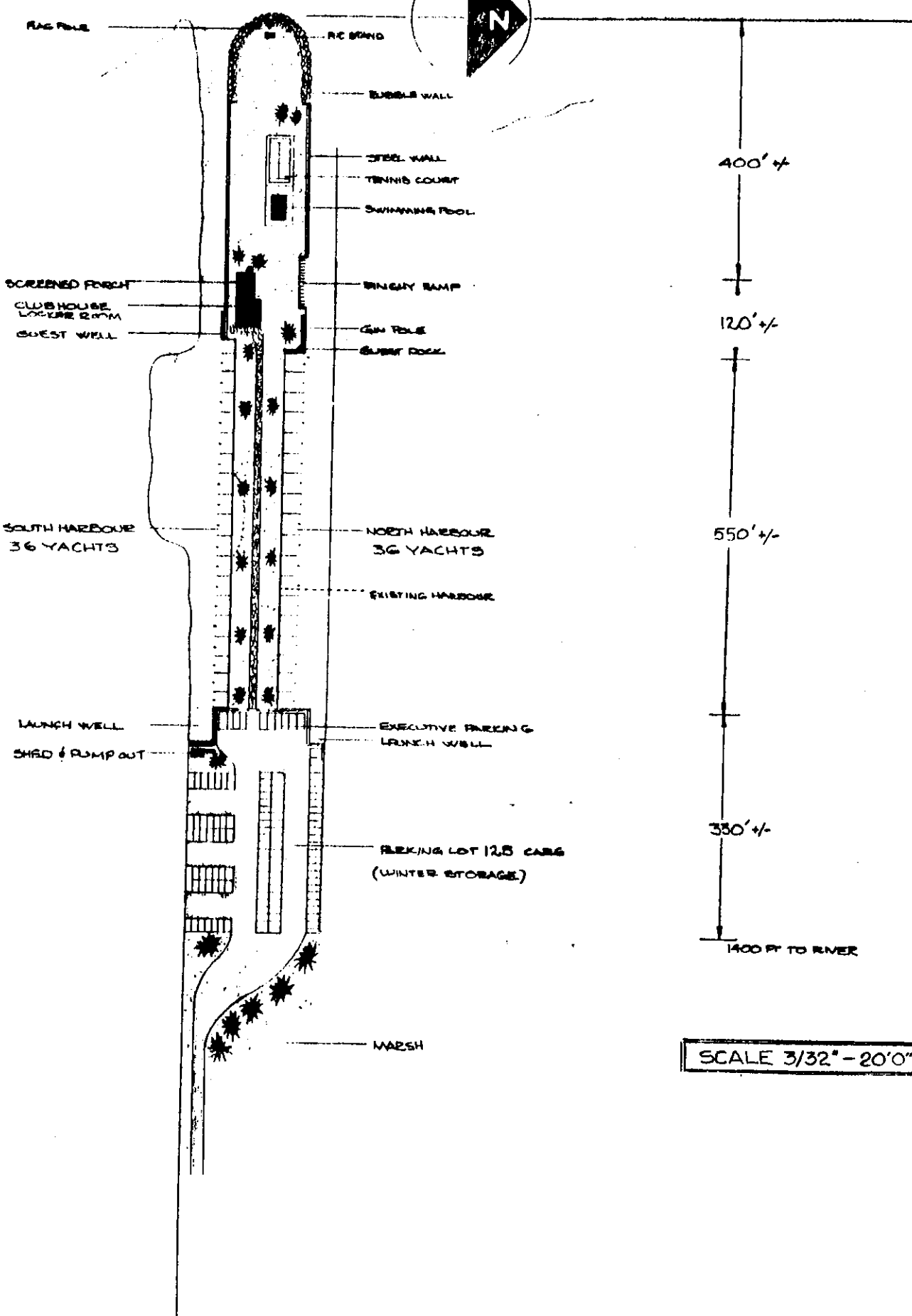

SCALE 3/32" = 20'0"